

Exclusively For:

**MDUSD Pleasant Hill
Middle School**

INTAKE MEETING REVIEW

Attendees: Jenelle Nikolai (PH), Sarah Baergen (PH), Alex Emmont (Director), Paula

- Requirements:**
- Sophisticated dining experience
 - Café Style
 - Some use of mascot, but not a lot
 - Menu boards
 - Like wood, brick, and metal texture
 - New serving lines

Overall Objective: Revamp space with modern graphics, décor, and equipment. Create a space students and staff are excited to occupy.

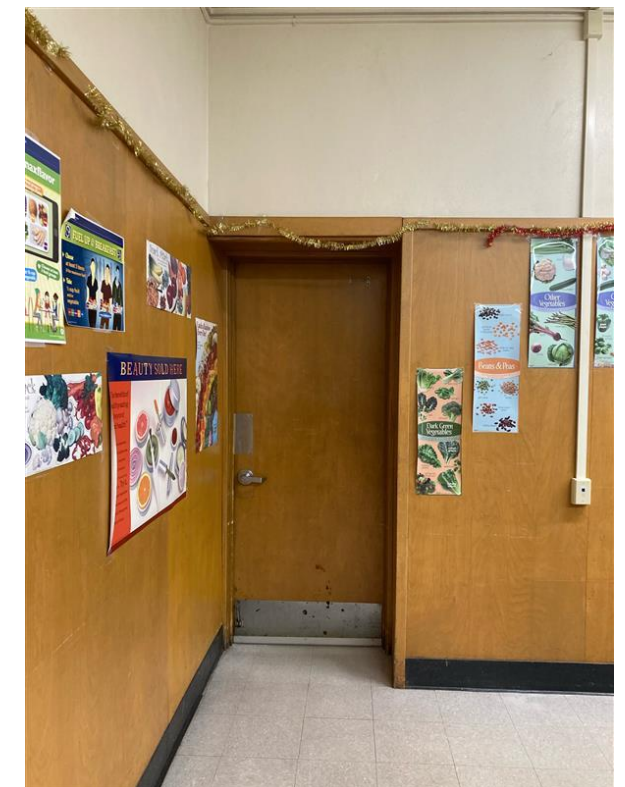

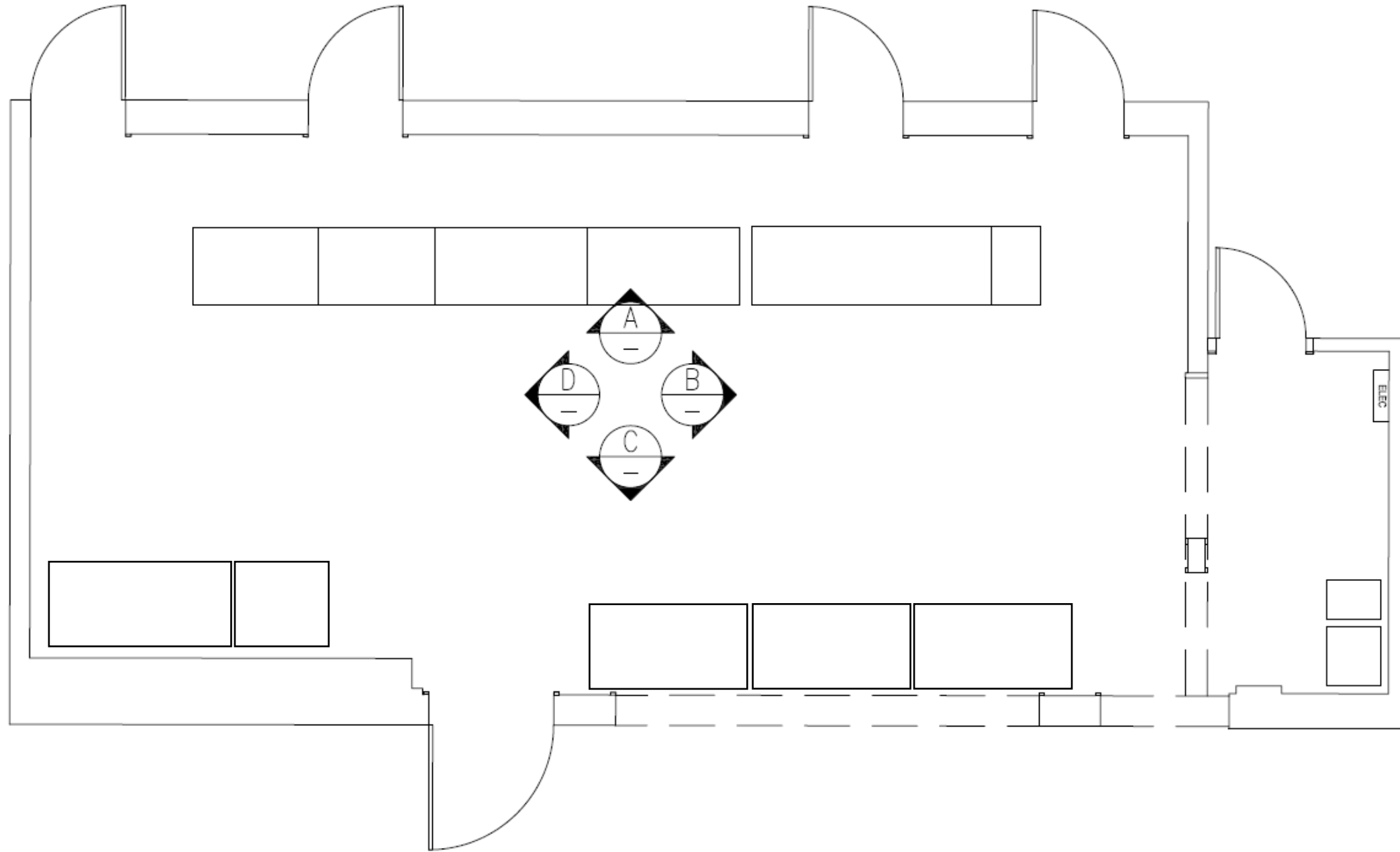

ELEVATION PLAN



OPTION A



A INTERIOR ELEVATION A
PLEASANT HILL MIDDLE SCHOOL

NOTE: School will need to remove wood trim piece between two center doors. Wood paneling can remain.

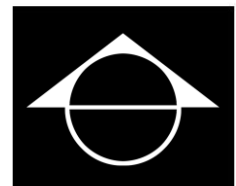

OPTION B



All conduit within graphic to be painted PT4 to blend in with the graphic imagery

A INTERIOR ELEVATION A
PLEASANT HILL MIDDLE SCHOOL

NOTE: School will need to remove wood trim piece between two center doors. Wood paneling can remain.

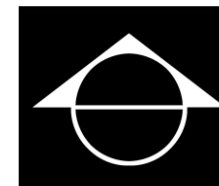

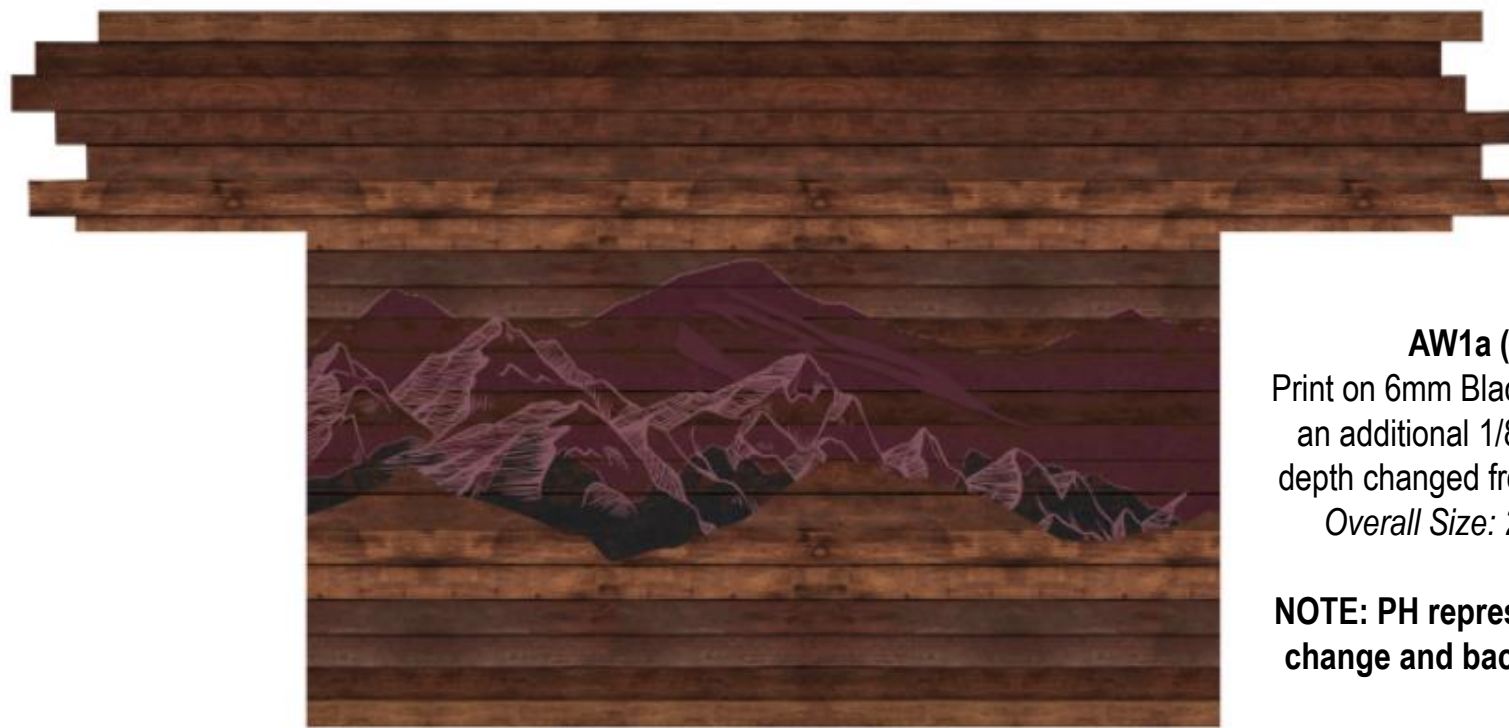

OPTION A (recommended)



OPTION B

AW1a (OPTION A & B)

Print on 6mm Black PVC. Top 42" with need an additional 1/8" backing to account for depth changed from paneling to sheetrock.
Overall Size: 252.25"W x 120.125"H

NOTE: PH representative to check depth change and backing thickness needed.

AW1b

Top Layer: Direct print on 3mm Silver Dibond, cut to shape and wall mounted with 2.5" Silver Standoffs.
 Bottom Layer: Second surface print on 3mm Clear acrylic, White Backlit.
81.9"W x 24"H



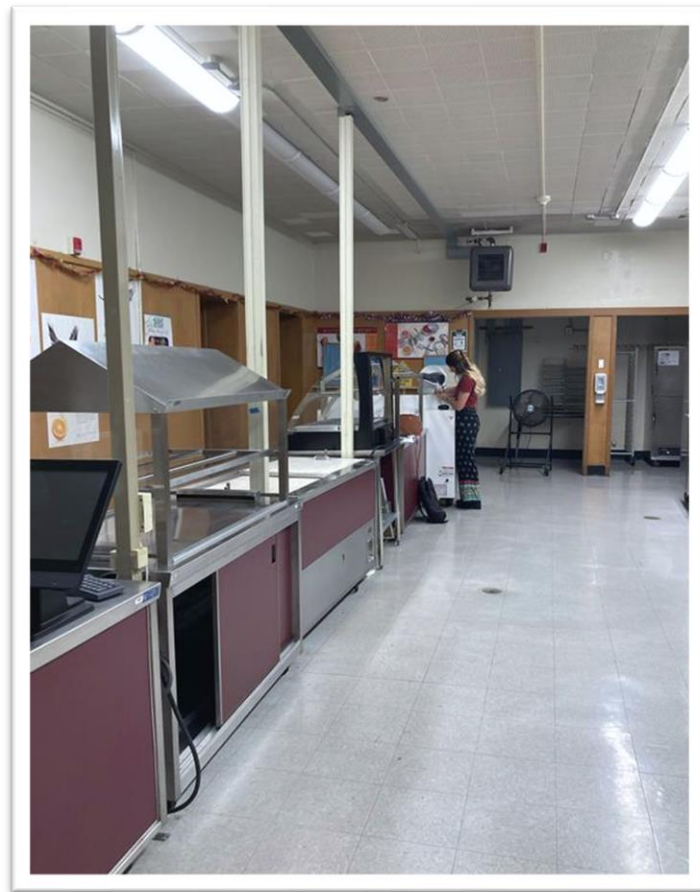
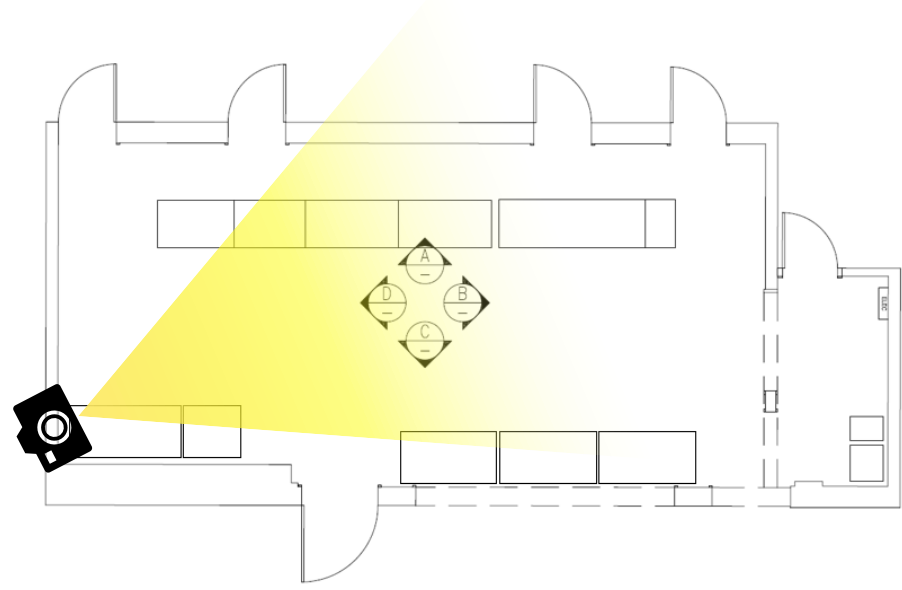

SHOWN WITH OPTION AW1a OPTION A



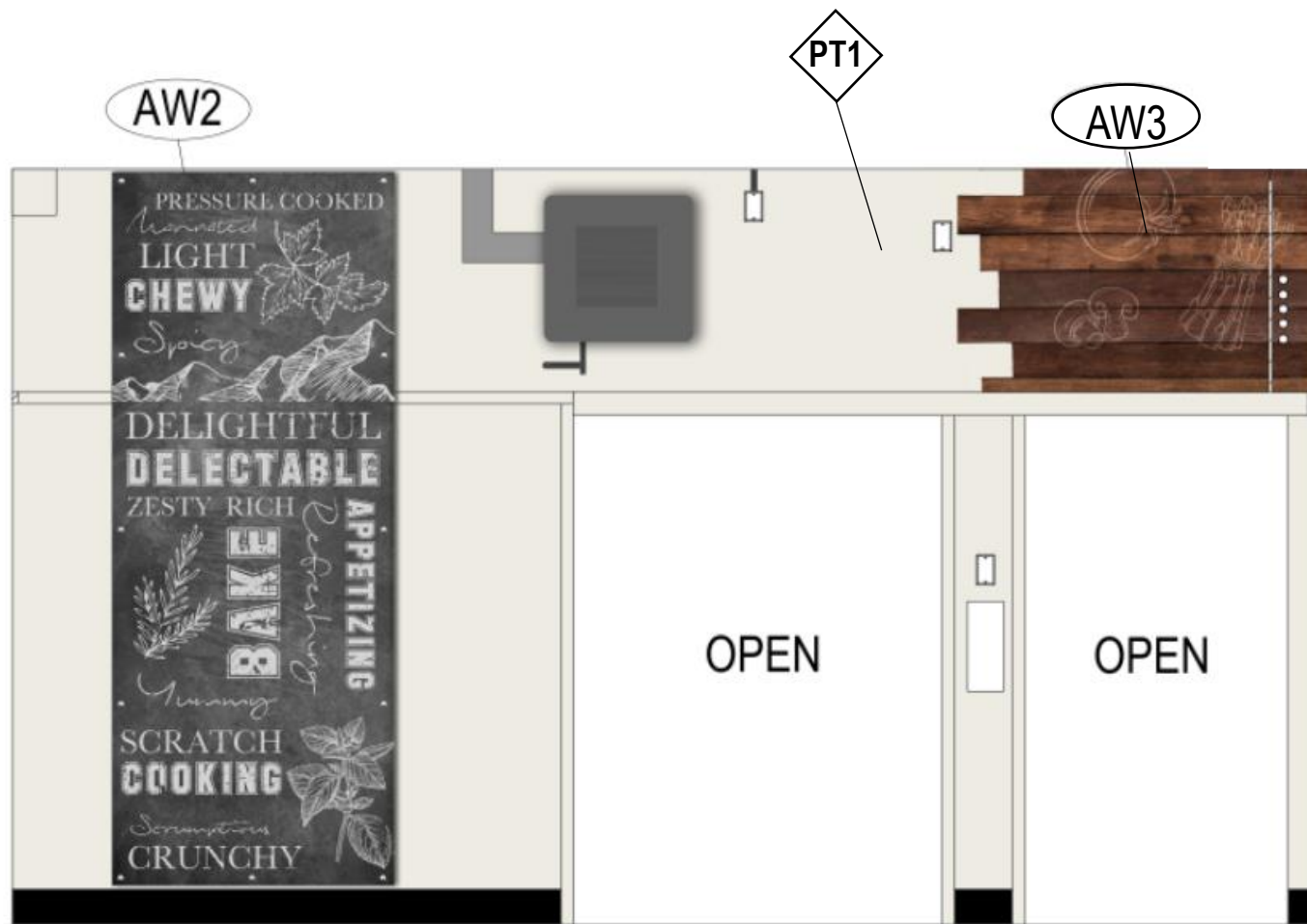

B INTERIOR ELEVATION B
PLEASANT HILL MIDDLE SCHOOL

NOTE: School is responsible to remove unwanted wall-hung items and patch walls prior to painting.

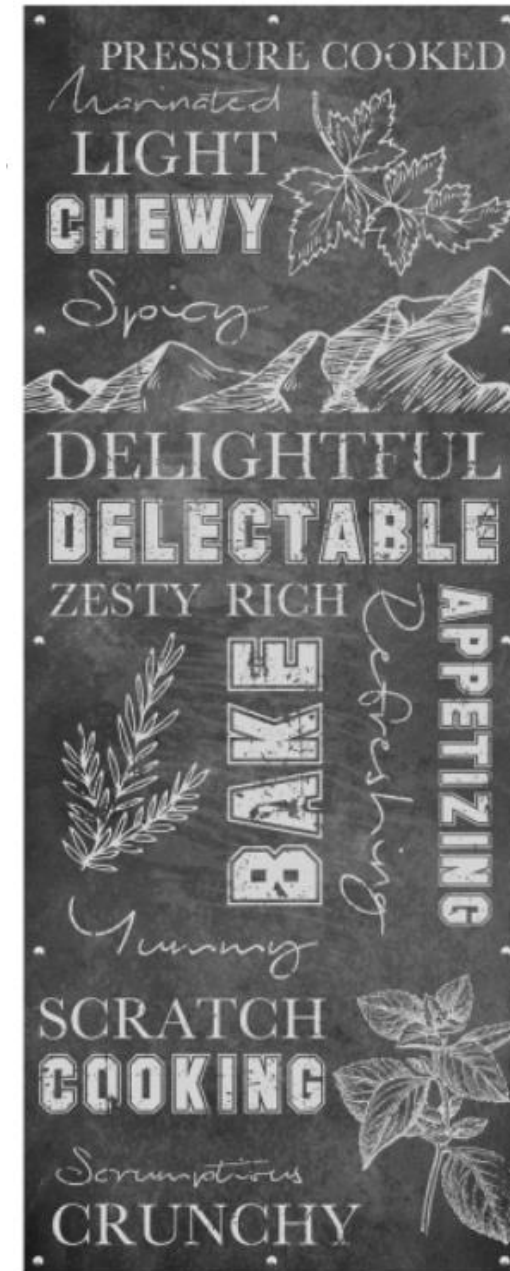

AW2
Print on 6mm clear acrylic.
First Surface Print – Text
Second Surface Print – Icons & Chalkboard texture
Wall mounted with 2" Silver Standoffs.
Overall Size: 47"W x 119"H



AW3
Print on 6mm Black PVC, cut to shape and wall mounted with snap caps.
Overall Size: 59"W x 37.125"H

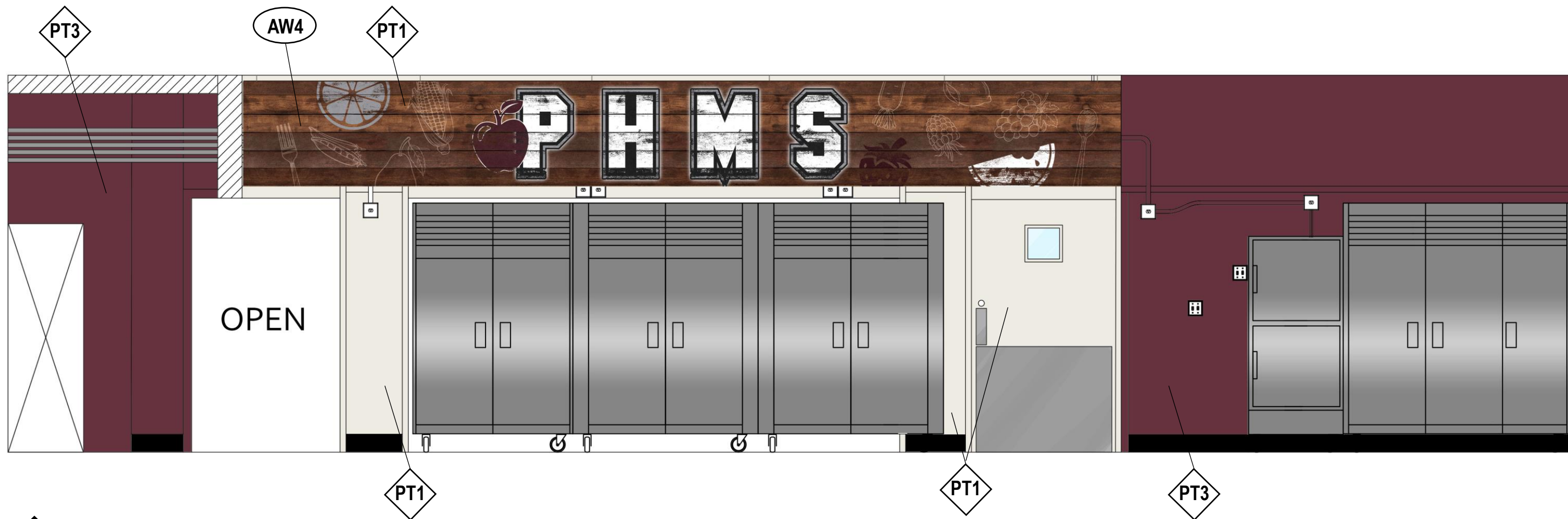

C INTERIOR ELEVATION C
PLEASANT HILL MIDDLE SCHOOL

NOTE: School is responsible to remove unwanted wall-hung items and patch walls prior to painting.



AW4

Print on 13mm Black Gatorplast, suspended
2" from the ceiling with silver aircraft cable.
Overall Size: 294.875"W x 35.125"H

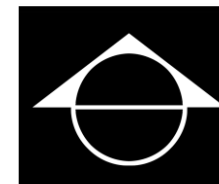

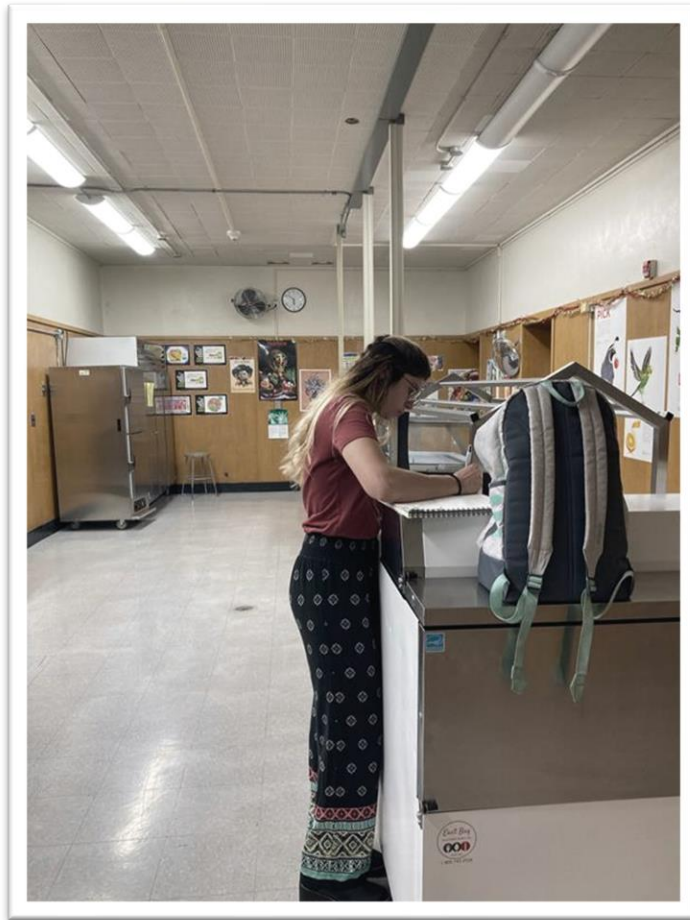
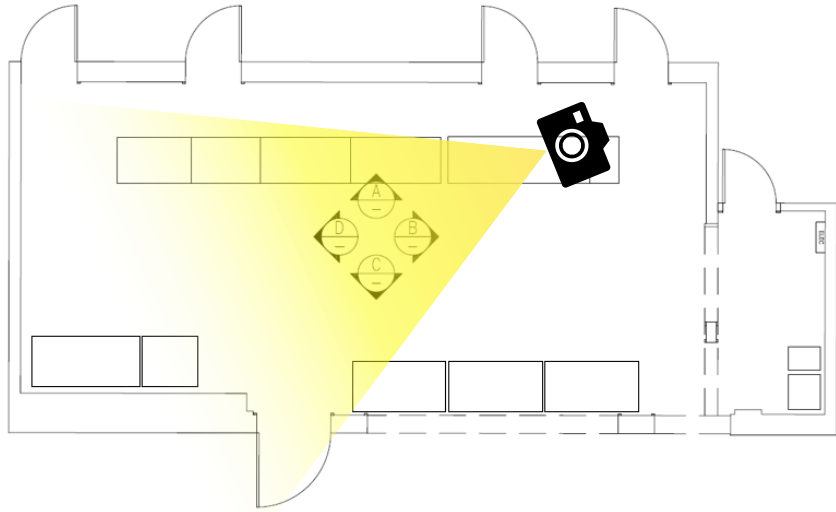

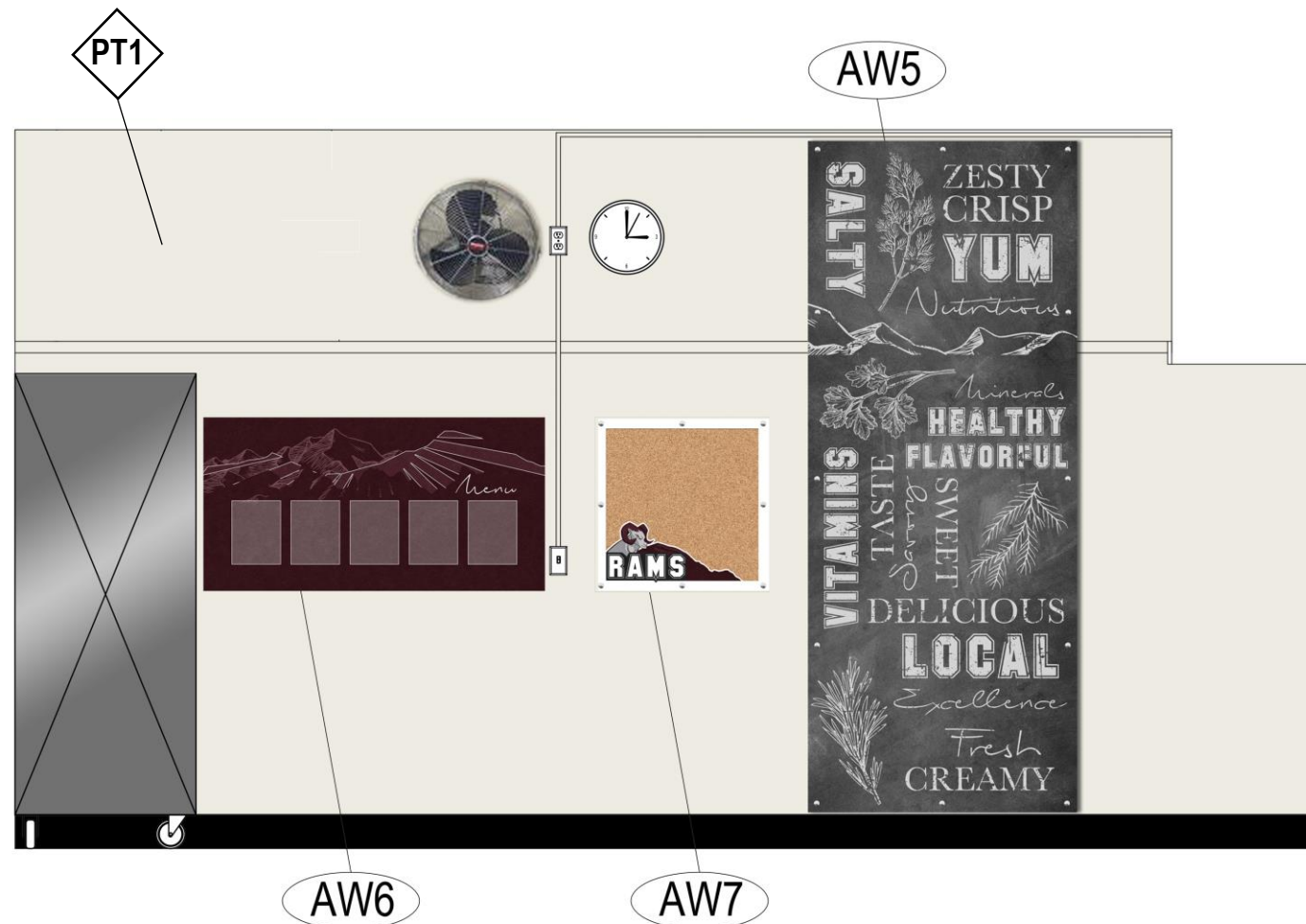

D INTERIOR ELEVATION D
PLEASANT HILL MIDDLE SCHOOL

NOTE: School is responsible to remove unwanted wall-hung items and patch walls prior to painting.



AW5
Print on 6mm clear acrylic.
First Surface Print – Text
Second Surface Print – Icons & Chalkboard texture
Wall mounted with 2" Silver Standoffs.
Overall Size: 47"W x 117.5"H

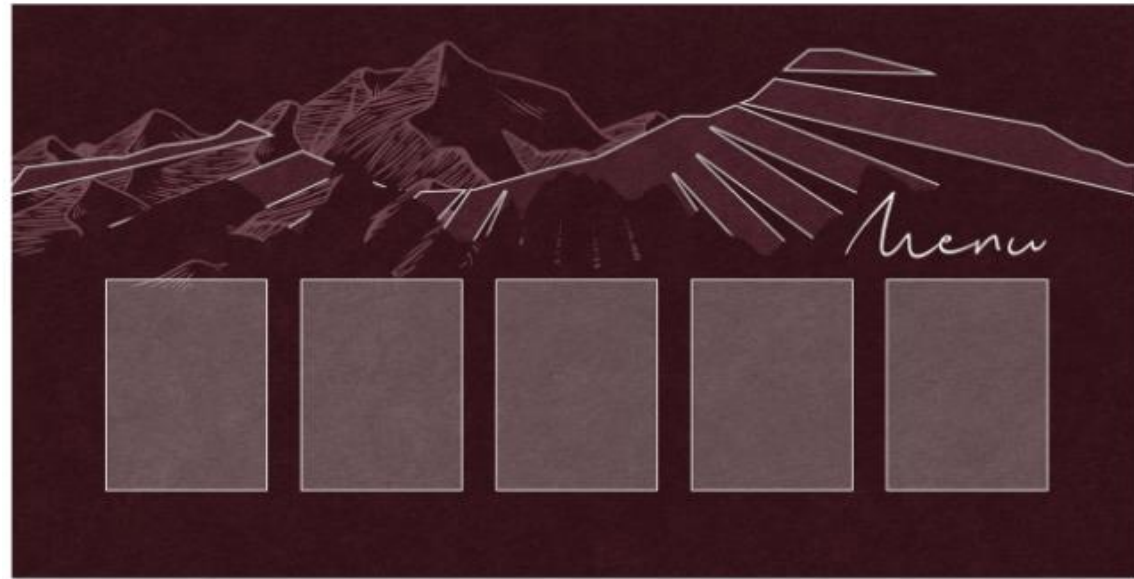

AW6

Direct print on 6mm Black PVC, wall mounted with snap caps and (5) 8.5 x 11 clear acrylic sleeves.
Overall Size: 59"W x 30"H

AW7

Top Layer: Second surface print on 6mm Clear Acrylic, cut to shape. Wall mounted with 1" Standoffs.
Bottom Layer: Cork insert cut to shape and wall mounted with 6mm Black PVC Backer and snap caps.
Overall Size: 30"W x 30"H

**Note: this board is meant to post mandatory posters and not intended for daily change. Two people will be needed to remove acrylic piece and access cork board when needed.*

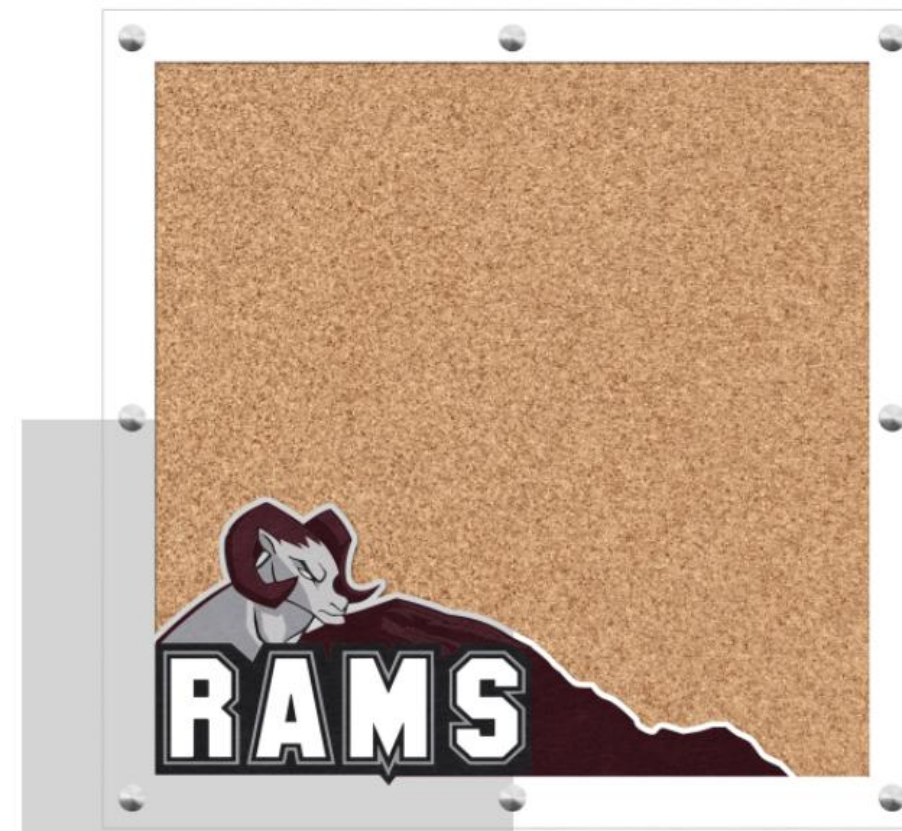

Gray Box to show transparency .



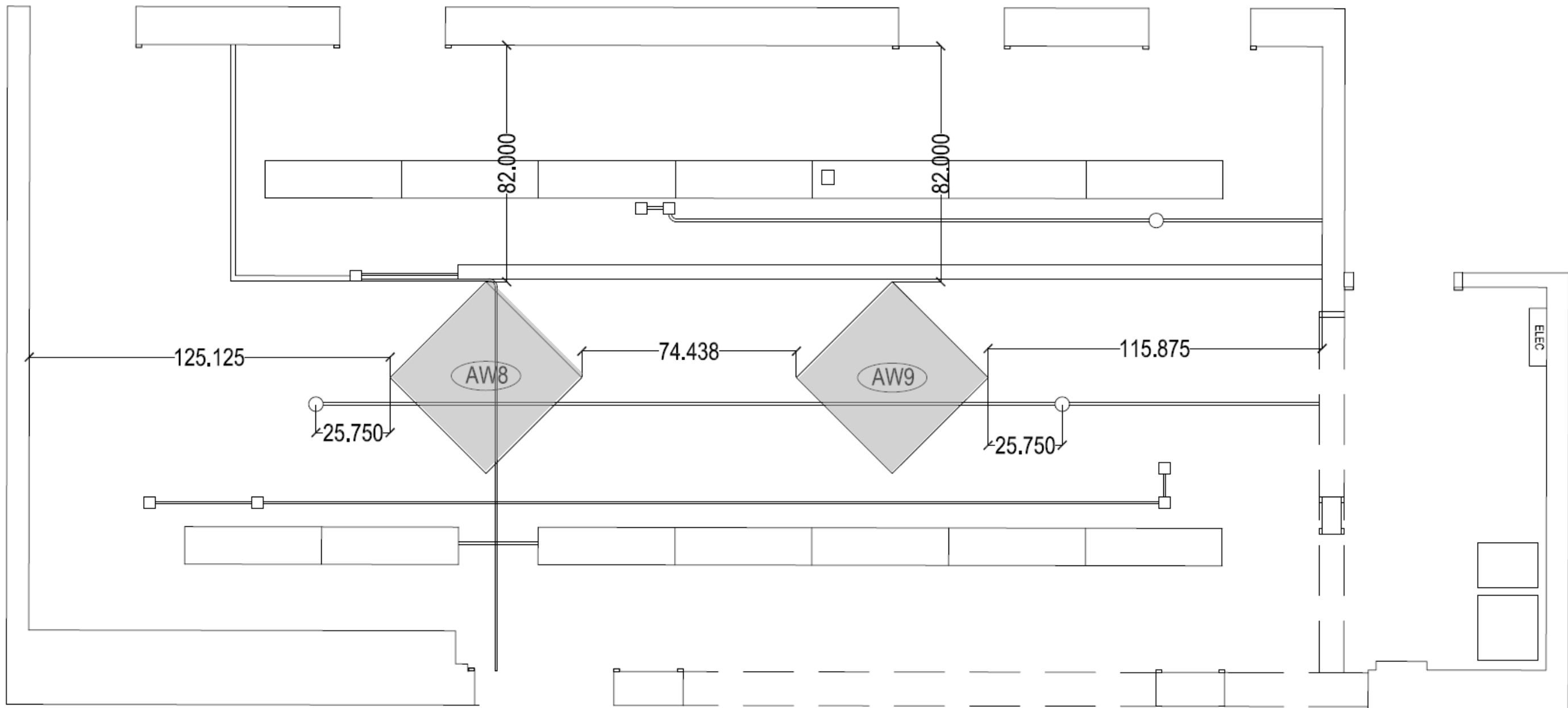

REFLECTED CEILING PLAN



AW8 OUTSIDE



AW8 INSIDE



AW9 OUTSIDE



AW9 INSIDE



AW8-AW9

Double Sided print on 13mm White Gatorplast. Ceiling hung
6" from ceiling with silver aircraft cable

Overall Size of Each: 47"W x 47"D x 16"H



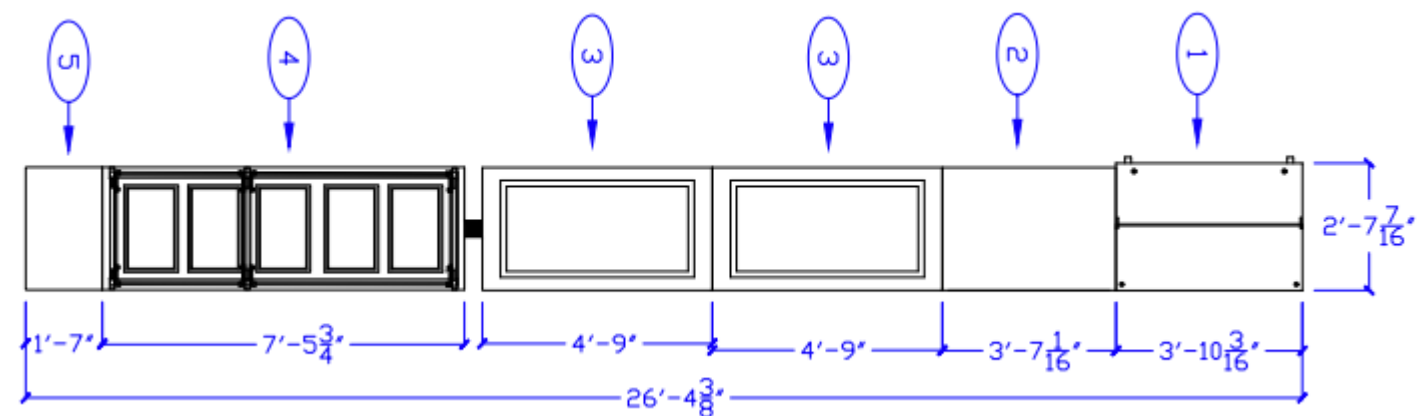

PLAN VIEW (DOUBLE SIDED LINE)



BACK VIEW - CUSTOMER

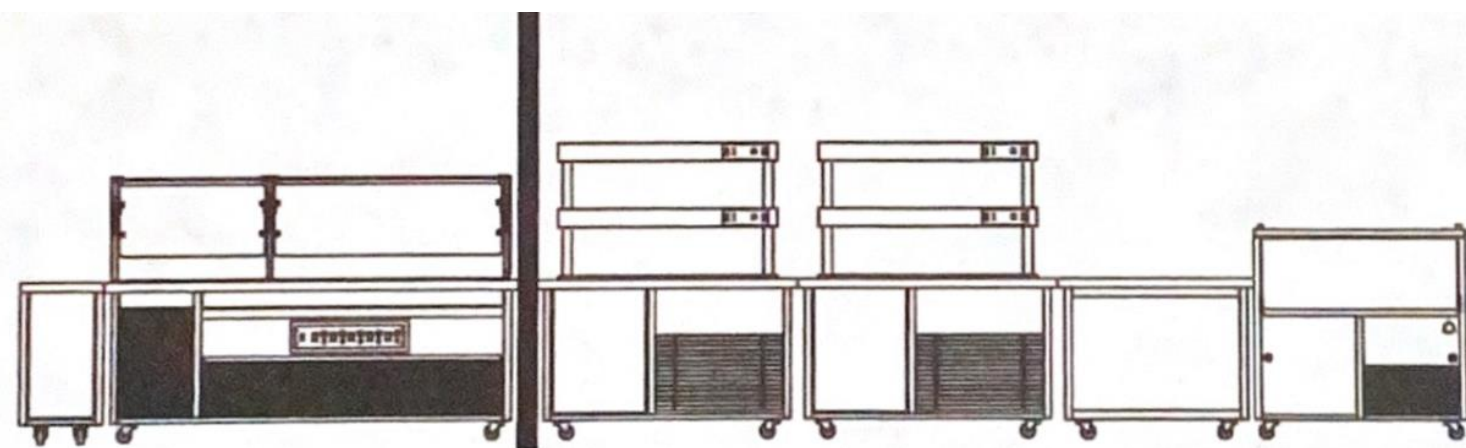

FRONT VIEW - SERVER

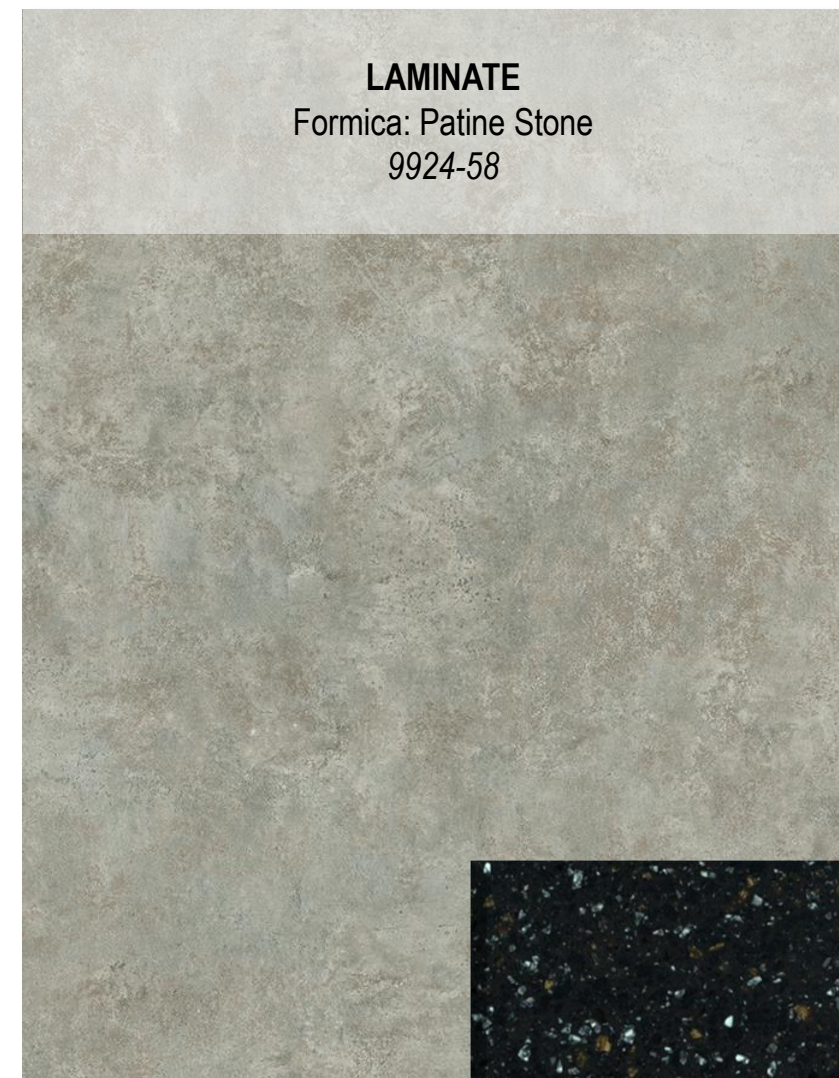

SW 7008

Alabaster



SW 6991

Black Magic



SW 6300

Burgundy



SW7520

Dark Brown



School is responsible for materials and labor

PREPARATION

Walls need to be properly prepped and sanded for proper paint adhesion. We then recommend at least one coat of standard Bonding Primer.

PAINT & SHEEN

We recommend all paint is Pre-Cat latex epoxy paint (all single component) in a satin sheen. These recommendations are not a requirement if the paint professional has reasoning for a different specification.



PH is responsible for materials and labor



PROJECT HISTORY

PRELIM DATE: 7.18.24

REVISION 1: 9.3.24

- AW1a: material & mounting hardware changed
- AW2: imagery altered
- AW5: imagery altered
- AW8: imagery altered

REVISION 2: 9.19.24

- AW1a: Option B added
- AW9: Imagery altered

FINAL BOOK APPROVAL

*Signing below indicates all project furniture quantities, colors, laminates, paint, graphic content & all other design elements have been reviewed and will receive no additional revisions. Any revisions requested beyond final book approval will incur additional charges and extended lead times.

**Client indicates an understanding that materials, colors, and artwork in this book are digital representations only and there may be variation in appearance due to screen calibration and/or color print anomalies.

Print Name: _____ Title: _____

Signature: _____ Date: _____



TERMS & CONDITIONS

TRASH REMOVAL

Dumpsters and trash haul away are not part of any provided installation pricing. Any waste, dunnage or packaging materials from delivery and installation will be compacted and neatly left on site. If dumpsters are required, special arrangements will be made with costs included on quote.

NEW or REMODEL PROJECTS

Palmer Hamilton is NOT responsible for site verifications unless they have entered into a design agreement contract with the customer. Dealer/end-user takes full responsibility of ensuring furniture and décor will fit. Please *verify* room dimensions prior to ordering. If drawing was scaled, traced or copied, please field verify all room dimensions for accuracy. If field dimensions can not be obtained, late shipments may occur.

Do not scale off these plans. If scaled plans are needed, please contact the project manager.

Palmer Hamilton is not responsible for changes, or deletions not reviewed and approved in advanced by Palmer Hamilton.

If half-walls or furnishings are to be clipped-down to floor, the Dealer/End-user is responsible to inform Palmer Hamilton of the locations. Palmer Hamilton is not responsible or liable for any electrical or plumbing that may be in the floors.

Please advise Palmer Hamilton if there is Asbestos in or around the location of the installation.

ADA COMPLIANT SEATING

A minimum of 5% but not less than one table shall be placed for wheelchair compliance. Palmer Hamilton is not responsible if the client has requested to provide less than this number in their facility. It is the responsibility of the end user to meet the compliancy standards.

It is also the responsibility of the end user to know their fire code capacity limits.

ELECTRICAL

Palmer Hamilton will suggest and supply the light fixtures if requested by the customer.

Palmer Hamilton installers do not install light fixtures as our installers are not electrical contractors and do not hold local licenses. School is responsible for all wiring and hooking up of the light fixtures. Palmer Hamilton will supply a lighting fixture plan of requested locations for the Schools electrician to use for placement of lighting fixtures

WINDOWS

School is responsible for any/all repair of window glass, trim and window caulking if necessary, prior to the installation.

School is responsible for cleaning of windows for window cling installation. If windows are not cleaned prior to installation, Palmer Hamilton will assess an additional charge for cleaning.

School is responsible for removing any window treatments that are not staying in new design.

WALLS

School is responsible for cleaning walls of any and all hooks, bulletin boards not remaining in design, loose wiring, removable clocks, conduit if not necessary.

Repair/Patching of any broken drywall and cracks in CMU, prior to installation.

Any newly constructed walls must be primed and painted prior to installation.

Any painting that is not supplied by Palmer Hamilton needs to be completed fourteen (14) days prior to our installation to properly cure.

CEILING

Palmer Hamilton does not sell or install standard ceiling tiles. Palmer Hamilton will remove or replace tiles if it is part of a décor item only. Our installers will only install any décor that might be attached to the ceiling and not to the tile grid for safety reasons as required.

FLOORING

Palmer Hamilton may specify a suggested flooring, but takes no liability in regard to floor performance, installation, and/or upkeep.

Any new flooring must be completed fourteen (14) days prior to installation to allow ample curing time of adhesives, and cleaning of flooring must also be completed prior to Palmer Hamilton installers being onsite for installation.

If Nonstandard glides are needed, it is the responsibility of the end-user to inform Palmer Hamilton of the type needed and cost will be added to the quote.

Vinyl Base trim must be completed prior to Palmer Hamilton furniture installation, unless the decision was made during the design phase by the client to have Palmer Hamilton installers install the base trim.

EXISTING EQUIPMENT AND FURNITURE

Please remove all equipment and furniture that is not to be in the new design plan prior to Palmer Hamilton's arrival.

I agree to terms & conditions

Signature _____ Date: _____

