

SITE PLAN LEGEND

--- THE ACCESSIBLE PATH OF TRAVEL AS INDICATED ON PLANS IS A BARRIER FREE ACCESS WITHOUT ANY ABRUPT VERTICAL CHANGES EXCEEDING 1/2" @ 1:2 MAXIMUM SLOPE, EXCEPT THAT LEVEL CHANGES DO NOT EXCEED 1/4" VERTICAL. MAX. GROSS SLOPE OF 2% ACCESSIBLE PATH OF TRAVEL SHALL BE SLIP RESISTANT WITH MAX. GROSS SLOPE OF 2%. MAINTAIN 48" MIN. WIDTH.

--- FIRE TRUCK ACCESS

--- ASSUMED PROPERTY LINE

(E) EXISTING FIRE HYDRANT

KEY NOTES

1 NEW ELECTRICAL EQUIPMENT PAD W/ LOCKABLE UTILITY DISCONNECT SEE ELECTRICAL DRAWINGS

2 ELECTRICAL EQUIPMENT TIE IN

LOCAL FIRE AUTHORITY REVIEW

LOCAL FIRE AUTHORITY TO INITIAL THE ITEMS AS APPLICABLE TO THIS PROJECT AND SIGN BELOW.

YES	NO	N/A	ELEVATORS
<input type="checkbox"/>	<input type="checkbox"/>	<input checked="" type="checkbox"/>	ELEVATORS THAT DO NOT HAVE CABS SIZED PER 2010 CBC CODE REQUIREMENTS HAVE BEEN IDENTIFIED AND THE LOCAL FIRE AUTHORITY APPROVES THE USE OF STAIRWAYS FOR EMERGENCY RESCUE AND PATIENT TRANSPORT.
<input checked="" type="checkbox"/>	<input type="checkbox"/>	<input type="checkbox"/>	ACCESS FIRE ROADS, FIRE HYDRANTS, AND WILDLAND-URBAN INTERFACE (WUI) CALIFORNIA CODE OF REGULATIONS - ACCESS ROADS & 2010 CFC - GATES TO SCHOOL SITES.
<input type="checkbox"/>	<input type="checkbox"/>	<input checked="" type="checkbox"/>	FIRE FLOW, FIRE HYDRANT LOCATION AND DISTRIBUTION ARE IN ACCORDANCE WITH 2010 CALIFORNIA FIRE CODE AND/OR NFPA 1142.
<input type="checkbox"/>	<input type="checkbox"/>	<input checked="" type="checkbox"/>	WILDLAND URBAN INTERFACE AREA? (2010 CBC CHAPTER 7A).
<input type="checkbox"/>	<input type="checkbox"/>	<input checked="" type="checkbox"/>	AUTOMATIC FIRE SPRINKLER SYSTEMS (AFSS)
<input type="checkbox"/>	<input type="checkbox"/>	<input checked="" type="checkbox"/>	THE LOCATION(S) OF THE PROPOSED POST INDICATOR VALVE (PIV) AND FIRE DEPT. CONNECTION (FDC) MEETS THE REQUIREMENTS OF THIS JURISDICTION.
<input type="checkbox"/>	<input type="checkbox"/>	<input checked="" type="checkbox"/>	THE LOCATION(S) OF THE DETECTOR CHECK VALVE ASSEMBLY (DCVA) MEET THE REQUIREMENTS OF THIS JURISDICTION.
<input type="checkbox"/>	<input type="checkbox"/>	<input checked="" type="checkbox"/>	THE FIRE PUMP ASSEMBLY/BACKFLOW PREVENTER AND OTHER VALVES MEET THE REQUIREMENTS OF THIS JURISDICTION.

PROJECT NAME: SILVERWOOD ELEMENTARY SCHOOL DSA APP NO: _____
 PROJECT LOCATION: 1649 CLAYCORD AVENUE, CONCORD, CALIFORNIA 94521
 LOCAL FIRE AUTHORITY: Contra Costa County Fire Protection District
 ADDRESS: 2010 Geary Road
 CITY/STATE/ZIP: Pleasant Hill, Ca. 94523-4619
 PHONE NUMBER: 925.941.3300 DATE: _____
 APPROVAL SIGNATURE: _____
 NAME AND TITLE: Ted Leach, Fire Inspector
 COMMENTS (PRINT): _____

INITIALS AND SIGNATURE ABOVE SIGNIFY THAT THE LOCAL FIRE AUTHORITY HAS REVIEWED THE LISTED ITEMS AND WAS CONSULTED REGARDING THEIR PLACEMENT AND DESIGN. THE CURRENT CONFIGURATION SHOWN ON THIS SITE PLAN, AS OF THIS DATE, MEETS WITH THEIR CURRENT STANDARDS. LOCAL STAMPS W/ SIGNATURE INDICATES ALL ITEMS ABOVE HAVE BEEN REVIEWED.

CODE ANALYSIS

PARKING COUNT SUMMARY

PARKING LOT	STANDARD	ACCESSIBLE*		ACCESSIBLE - VAN*		TOTAL	% COVERED	ACCESSIBLE SPACES COVERED
		REQUIRED	PROVIDED	REQUIRED	PROVIDED			
PARKING LOT - A	26	2	2	1	1	28	-	-

ARRAY CODE ANALYSIS/ SELECTION TABLE

ARRAY #	OCC. TYPE	CONSTR. TYPE	ACTUAL AREA	SPRINKLERED	BASIC ALLOWABLE AREA	ARRAY DESIGN:	FOUNDATION DESIGN	
							PIER TYPE	PIER CONDITION (SEE PIER DESIGN TABLE)
1	A-3	IIB	6,486	N	9,500 SF	128 A APP# 02-111702	1/S3.1-2A	1A
2	A-3	IIB	728	N	9,500 SF	128 A APP# 02-111702	1/S3.1-2A	1A

ITEM: REVISIONS/ISSUE: DATE:

CD SUBMITTAL	DATE
	06/07/11

ATI
 ARCHITECTS
 +
 ENGINEERS

www.atiae.com

3860 Blackhawk Road Danville, CA 94505 T 925.648.8900
 2510 Douglas Boulevard Roseville, CA 95661 T 916.772.1800
 3050 Pullman Street Costa Mesa, CA 92626 T 714.338.1600
 1901 Orange Tree Lane Redlands, CA 92374 T 909.801.8160

PROFESSIONAL STAMP:

ARCHITECT
 MARY S. BELO
 C 20677
 Exp: Mar. 31, 2011
 STATE OF CALIFORNIA

APPROVALS:

PROJECT TITLE:
SUNPOWER ELEVATED SOLAR CANOPY SILVERWOOD ELEMENTARY MT. DIABLO UNIFIED SCHOOL DISTRICT

SITE PLAN

DATE: 04/11/11 SCALE: AS NOTED
 DRAWN BY: BB/RC CHECKED BY: MB
 JOB NO: SA8504.033
 CAD FILE: +A01-SI-SITE.dwg
 SHEET NO:

A0.1-SI

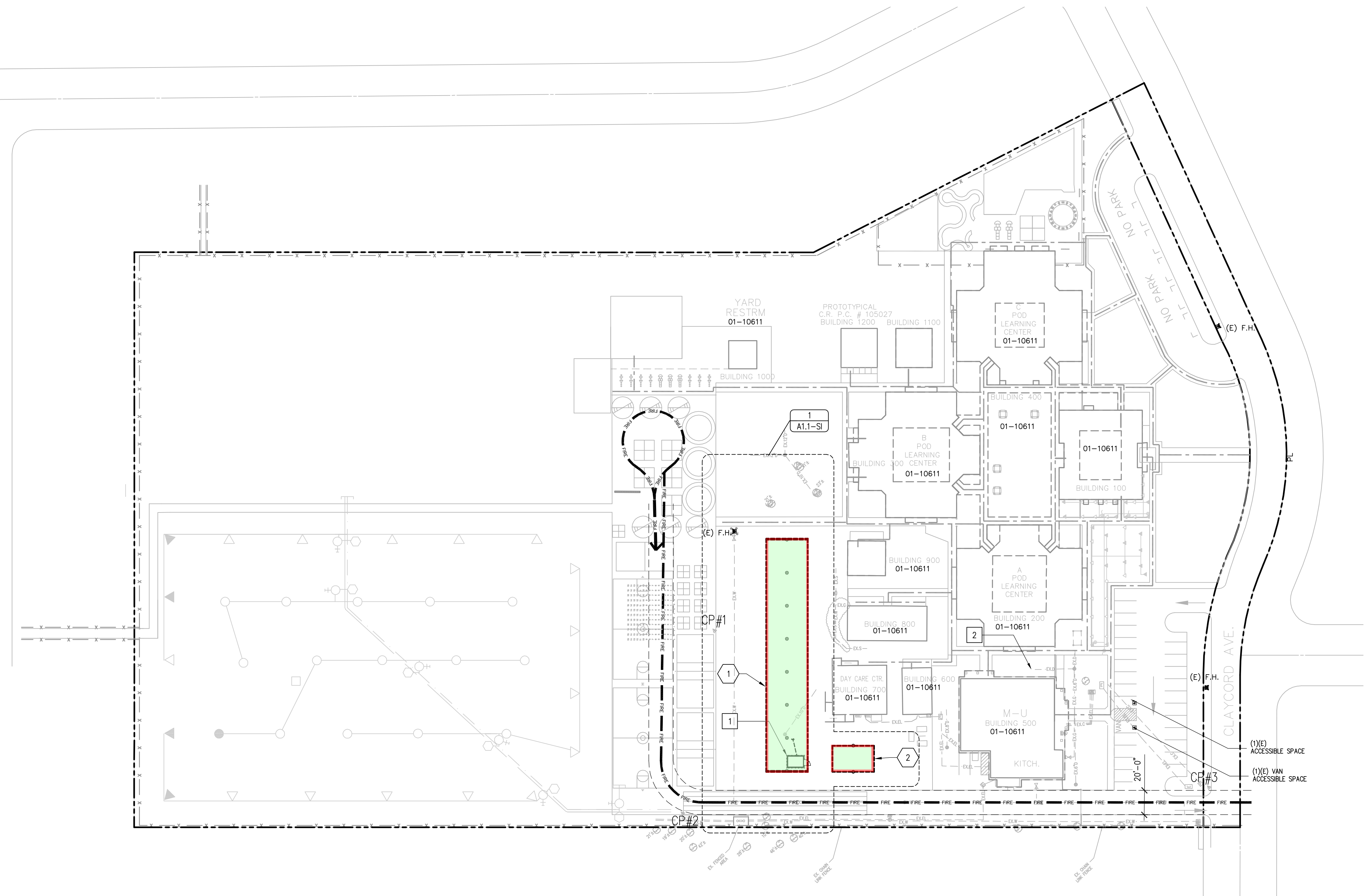

1 SITE PLAN

THIS DOCUMENT, AND THE INFORMATION CONTAINED HEREIN, ARE THE SOLE PROPERTY OF ATI ARCHITECTS & ENGINEERS AND SUNPOWER CORPORATION. ANY USE OR MODIFICATIONS OF THIS DOCUMENT, IN WHOLE OR IN PART, WITHOUT THE WRITTEN PERMISSION OF ATI ARCHITECTS AND ENGINEERS, IS STRICTLY PROHIBITED.