

ITEM	REVISIONS/ISSUE	DATE
	CD SUBMITTAL	06/01/11

**ATI**  
ARCHITECTS  
+  
ENGINEERS

www.atiae.com

3860 Blackhawk Road  
Danville, CA 94526  
T 925.648.8800

2510 Douglas Boulevard  
Roseville, CA 95661  
T 916.772.1800

3050 Pullman Street  
Costa Mesa, CA 92626  
T 714.338.1600

1901 Orange Tree Lane  
Fidlands, CA 92374  
T 909.801.8160

PROFESSIONAL STAMP:

APPROVALS:

PROJECT TITLE:  
**SUNPOWER  
ELEVATED  
SOLAR CANOPY  
EAGLE PEAK  
ELEMENTARY  
MT. DIABLO UNIFIED  
SCHOOL DISTRICT**

**SITE PLAN**

DATE: 03/03/11  
SCALE: AS NOTED

DRAWN BY: BB/RC  
CHECKED BY: MB

JOB NO: SA8504.024

CAD FILE: +A01-EP-SITE.dwg

SHEET NO:

**A0.1-EP**

**SITE PLAN LEGEND**

- THE ACCESSIBLE PATH OF TRAVEL AS INDICATED ON PLANS IS A BARRIER FREE ACCESS WITHOUT ANY ABRUPT VERTICAL CHANGES EXCEEDING 1/2" @ 1:2 MAXIMUM SLOPE, EXCEPT THAT LEVEL CHANGES DO NOT EXCEED 1/4" VERTICAL MAX. GROSS SLOPE OF 2% ACCESSIBLE PATH OF TRAVEL SHALL BE SLIP RESISTANT WITH MAX. GROSS SLOPE OF 2%. MAINTAIN 48" MIN. WIDTH.
- FIRE TRUCK ACCESS
- ASSUMED PROPERTY LINE
- (E) EXISTING FIRE HYDRANT

**KEY NOTES**

- 1 NEW ELECTRICAL EQUIPMENT PAD W/ LOCKABLE UTILITY DISCONNECT SEE ELECTRICAL DRAWINGS
- 2 ELECTRICAL EQUIPMENT TIE IN

**LOCAL FIRE AUTHORITY REVIEW**

- LOCAL FIRE AUTHORITY TO INITIAL THE ITEMS AS APPLICABLE TO THIS PROJECT AND SIGN BELOW.
- | YES                                 | NO                       | N/A                                 | ELEVATORS   |
|-------------------------------------|--------------------------|-------------------------------------|---|
| <input type="checkbox"/>            | <input type="checkbox"/> | <input checked="" type="checkbox"/> | ELEVATORS THAT DO NOT HAVE CABS SIZED PER 2010 CBC CODE REQUIREMENTS HAVE BEEN IDENTIFIED AND THE LOCAL FIRE AUTHORITY APPROVES THE USE OF STAIRWAYS FOR EMERGENCY RESCUE AND PATIENT TRANSPORT.                        |
| <input checked="" type="checkbox"/> | <input type="checkbox"/> | <input type="checkbox"/>            | ACCESS FIRE ROADS, FIRE HYDRANTS, AND WILDLAND-URBAN INTERFACE (WUI) ACCESS ROADS AND GATE ENTRANCES ARE IN ACCORDANCE WITH TITLE 19, CALIFORNIA CODE OF REGULATIONS - ACCESS ROADS & 2010 CFC - GATES TO SCHOOL SITES. |
| <input type="checkbox"/>            | <input type="checkbox"/> | <input checked="" type="checkbox"/> | FIRE FLOW, FIRE HYDRANT LOCATION AND DISTRIBUTION ARE IN ACCORDANCE WITH 2010 CALIFORNIA FIRE CODE AND/OR NFPA 1142.  |
| <input type="checkbox"/>            | <input type="checkbox"/> | <input checked="" type="checkbox"/> | WILDLAND URBAN INTERFACE AREA? (2010 CBC CHAPTER 7A).   |
| <input type="checkbox"/>            | <input type="checkbox"/> | <input checked="" type="checkbox"/> | AUTOMATIC FIRE SPRINKLER SYSTEMS (AFSS)   |
| <input type="checkbox"/>            | <input type="checkbox"/> | <input checked="" type="checkbox"/> | THE LOCATION(S) OF THE PROPOSED POST INDICATOR VALVE (PIV) AND FIRE DEPT. CONNECTION (FDC) MEETS THE REQUIREMENTS OF THIS JURISDICTION.   |
| <input type="checkbox"/>            | <input type="checkbox"/> | <input checked="" type="checkbox"/> | THE LOCATION(S) OF THE DETECTOR CHECK VALVE ASSEMBLY (DCVA) MEET THE REQUIREMENTS OF THIS JURISDICTION.   |
| <input type="checkbox"/>            | <input type="checkbox"/> | <input checked="" type="checkbox"/> | THE FIRE PUMP ASSEMBLY/BACKFLOW PREVENTER AND OTHER VALVES MEET THE REQUIREMENTS OF THIS JURISDICTION.  |

PROJECT NAME: EAGLE PEAK ELEMENTARY DSA APP NO: \_\_\_\_\_  
 PROJECT LOCATION: 800 HUTCHINSON RD, WALNUT CREEK, CALIFORNIA 94598  
 LOCAL FIRE AUTHORITY: Contra Costa County Fire Protection District  
 ADDRESS: 2010 Geary Road  
 CITY/STATE/ZIP: Pleasant Hill, Ca. 94523-4619  
 PHONE NUMBER: 925.941.3300 DATE: \_\_\_\_\_  
 APPROVAL SIGNATURE: \_\_\_\_\_  
 NAME AND TITLE: Ted Leach, Fire Inspector  
 COMMENTS (PRINT): \_\_\_\_\_

INITIALS AND SIGNATURE ABOVE SIGNIFY THAT THE LOCAL FIRE AUTHORITY HAS REVIEWED THE LISTED ITEMS AND WAS CONSULTED REGARDING THEIR PLACEMENT AND DESIGN. THE CURRENT CONFIGURATION SHOWN ON THIS SITE PLAN, AS OF THIS DATE, MEETS WITH THEIR CURRENT STANDARDS. LOCAL STAMPS W/ SIGNATURE INDICATES ALL ITEMS ABOVE HAVE BEEN REVIEWED.

**CODE ANALYSIS**

**PARKING COUNT SUMMARY**

PARKING LOT	STANDARD	ACCESSIBLE*		ACCESSIBLE - VAN*		TOTAL	% COVERED	ACCESSIBLE SPACES COVERED
		REQUIRED	PROVIDED	REQUIRED	PROVIDED			
PARKING LOT-A	57	3	3	1	1	60	16%	1

**ARRAY CODE ANALYSIS/ SELECTION TABLE**

ARRAY #	OCC. TYPE	CONSTR. TYPE	ACTUAL AREA	SPRINKLERED	BASIC ALLOWABLE AREA	ARRAY DESIGN:	FOUNDATION DESIGN	
							PIER TYPE	PIER CONDITION (SEE PIER DESIGN TABLE)
1	S-2	IIB	2,639	N	26,000 SF	128 S APP# 02-111697	1/S3.1-2S	2S

PV PANELS HAVE A CLASS C RATING, PERMISSIBLE PER CBC 603.1.3

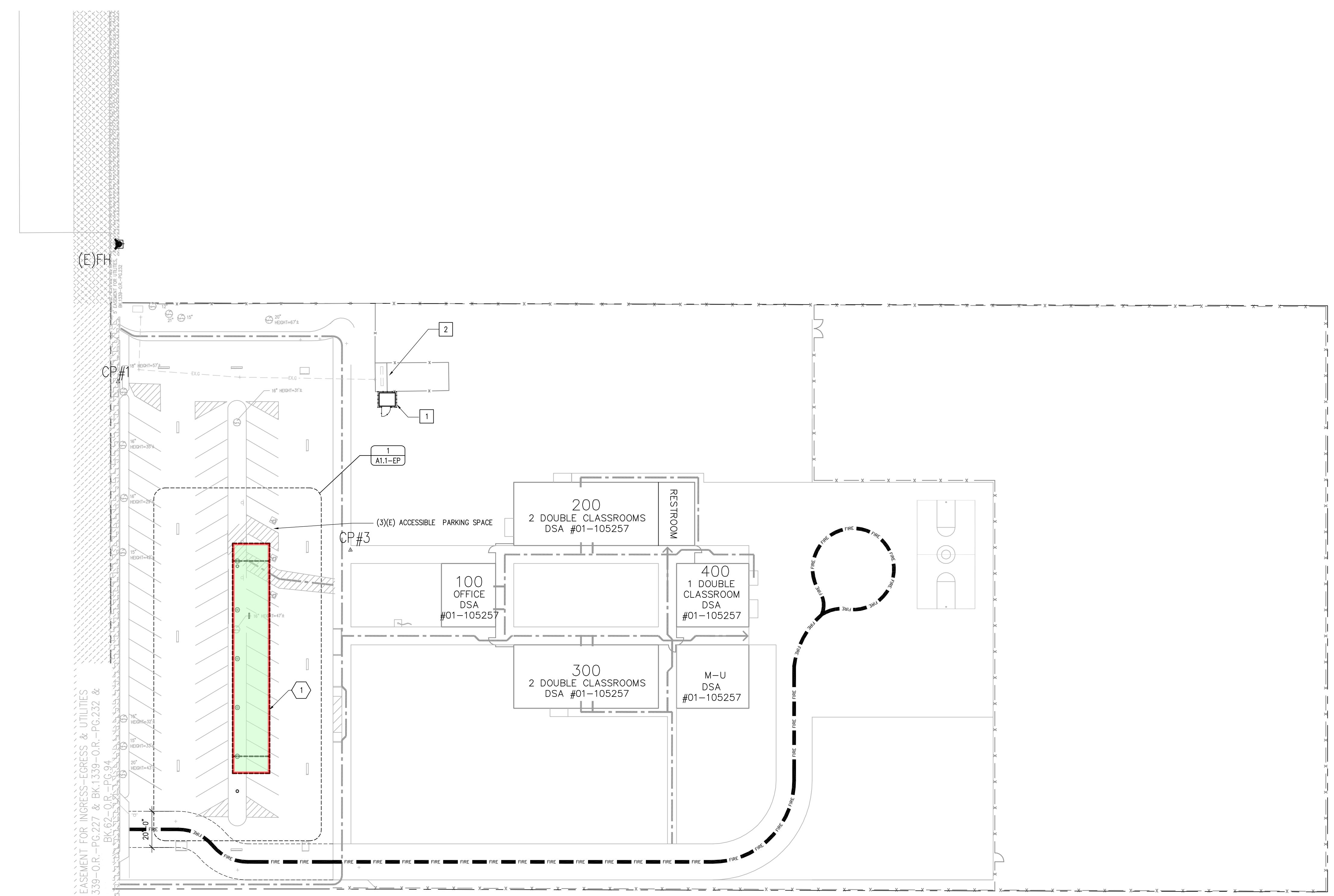

**1 SITE PLAN**

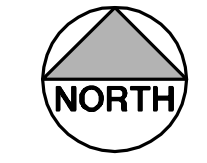
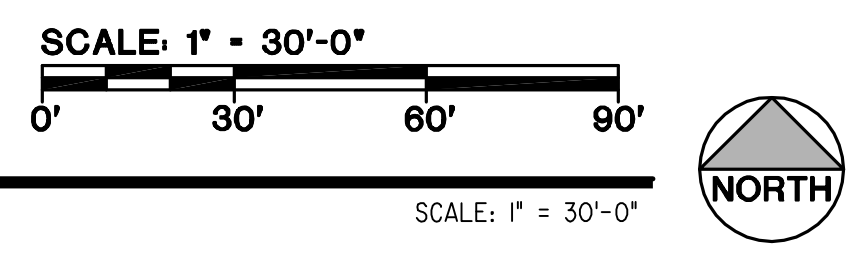

THIS DOCUMENT, AND THE INFORMATION CONTAINED HEREIN, ARE THE SOLE PROPERTY OF ATI ARCHITECTS & ENGINEERS AND SUNPOWER CORPORATION. ANY USE OR MODIFICATIONS OF THIS DOCUMENT, IN WHOLE OR IN PART, WITHOUT THE WRITTEN PERMISSION OF ATI ARCHITECTS AND ENGINEERS, IS STRICTLY PROHIBITED.